

PROJECT NOTES

- FIELD VERIFY AVAILABLE WATER PRESSURE FROM EXISTING IRRIGATION PUMP AT POINT OF CONNECTION AND NOTIFY THE LANDSCAPE ARCHITECT PRIOR TO BEGINNING ANY WORK.
- CONTACT DIG ALERT AT 1-800-227-2600 TO IDENTIFY AND LOCATE ALL ON SITE UTILITIES PRIOR TO BEGINNING WORK. THE CONTRACTOR SHALL COORDINATE WITH THE COUNTY OF VENTURA PUBLIC WORKS REPRESENTATIVE AND REVIEW THE EXISTING SITE PRIOR TO BEGINNING WORK TO AVOID CONFLICTS WITH EXISTING UTILITIES.
- SCH. 40 PVC LATERALS SHALL BE 3/4" IN SIZE UNLESS SPECIFICALLY IDENTIFIED ON THE PLAN AS 1" SIZE. ALL SCH. 40 PVC LATERALS ON THIS PROJECT SHALL BE TREATED WITH ULTRAVIOLET RESISTANT MATERIALS BY THE PIPE MANUFACTURER SUITABLE FOR USE FOR ON GRADE APPLICATIONS. ALL SCH. 40 PVC ULTRAVIOLET TREATED LATERALS INSTALLED ON GRADE SHALL BE STAPLED TO THE GRADE WITH #4X24" REBAR J-HOOKS AT 4'-0" O.C.
- THE CONTRACTOR SHALL BE RESPONSIBLE FOR ANY TRENCH SETTLING OR IRRIGATION HEAD SETTLING OR TILTING. ALL TRENCHES WILL BE BACK FILLED WITH CLEAN SOIL, COMPACTED AND, IF DEEMED NECESSARY BY THE COUNTY, BE PLANTED WITH NEW PLANTS AND MULCH GROUND COVER. ALL HEADS THAT SETTLE WILL BE RAISED AND STRAIGHTENED TO CONFORM TO THE DRIP EMITTER DETAIL. PROVIDE ADDITIONAL SOIL AS NECESSARY AND HAND TAMP AROUND HEAD TO PREVENT FUTURE SETTLING.
- INSTALL PVC SLEEVES FOR ALL PVC IRRIGATION PIPES INSTALLED UNDER PAVING. MAINLINE AND IRRIGATION PIPING SHALL BE SIZED WITH SLEEVE PIPING BEING 3 TIMES LARGER THAN THE PIPE SIZE INSERTED WITHIN THE SLEEVE. THIS NOTE APPLIES TO ANY POSSIBLE CONDITION ON SITE THAT IS DISCOVERED IN THE FIELD AT THE TIME OF CONSTRUCTION.
- THE IRRIGATION SYSTEM IS SHOWN DIAGRAMMATICALLY. BOTH LATERAL PIPING AND MAINLINE PIPING ARE ILLUSTRATED ON THE IRRIGATION PLAN FOR CLARITY PURPOSES. INSTALL ALL IRRIGATION EQUIPMENT WITHIN THE LIMIT OF WORK BOUNDARY WHENEVER POSSIBLE. INSTALL THE IRRIGATION MAINLINE IN A LOCATION WITHIN THE WORK BOUNDARY THAT PREVENTS IT FROM BEING INSTALLED DIRECTLY UNDER ANY NEW TREE PLANTING OR WITHIN ANY EXISTING TREE BRANCH CANOPY (DRIP LINE). COORDINATE THE EXACT LAYOUT OF THE IRRIGATION MAINLINE AND LATERAL SYSTEM AS WELL AS THE DEPTH OF THE IRRIGATION MAINLINE WITH THE COUNTY OF VENTURA REPRESENTATIVE AND OJAI VALLEY LAND CONSERVANCY REPRESENTATIVE PRIOR TO BEGINNING ANY WORK.
- INSTALL ALL MANUAL IRRIGATION VALVES A MINIMUM OF 12" ABOVE FINISH GRADE. POSITION DRIP FILTER ON DOWNSTREAM RISER SO THAT FILTER CAN BE EASILY ACCESSED BY MAINTENANCE STAFF. INSTALL MANUAL VALVES 30" APART FROM EACH OTHER.
- INSTALL ONLY PURPLE COLORED RECLAIMED WATER VALVE BOXES ON THIS PROJECT. PROVIDE AND INSTALL ALL VALVES BOX SIZES AS PER PLANS, DETAILS, AND SPECIFICATIONS.
- USE ONLY SCH. 80 PVC NIPPLES AND T.O.E. NIPPLES AS NEEDED FOR ALL THREADED VALVE ASSEMBLIES. NO SCH. 40 PVC MALE ADAPTERS WILL BE USED FOR ANY THREADED ASSEMBLY.
- INSTALL MANUFACTURER G.P.H. ALGAE AND ULTRA VIOLET RESISTANT FLEXIBLE PVC HOSE, 'STICKY STRIPE' SERIES, I.P.S. SIZE 3/8", MODEL NUMBER GPVCSSAR050IRR, FROM RIGID SCH. 40 PVC U.V. LATERAL PIPING TO EACH INDIVIDUAL PLANT ROOT BALL PIT. CUT TUBING LENGTH TO SIZE IN THE FIELD. SOLVENT WELD (2) G.P.H. PVC BLACK COLORED MALE ADAPTERS, MODEL G436073B, USING IPS P-70 PURPLE PRIMER AND IPS-795 PVC SOLVENT CEMENT. THREAD ONE MALE ADAPTER INTO SCH. 40 U.V. TREATED PVC LATERAL FITTING AND THE SPECIFIC IRRIGATION NOZZLE AS SPECIFIED ON PLAN ON THE END SUPPLYING WATER TO THE PLANT. SECURE THE FLEXIBLE TUBING TO GRADE USING G.P.H. GALVANIZED TUBING STAKES, MODEL GTDS050, AT 3'-0" O.C. ENSURE THAT EACH CONTAINERIZED PLANT HAS A 4" SOIL BASIN AROUND THE PERIMETER OF THE ROOT BALL TO CONTAIN THE IRRIGATION WATER WITHIN THE PLANT BASIN. THE SPECIFIC IRRIGATION NOZZLE SHALL BE PLACED AT THE OUTSIDE EDGE OF THE PLANT ROOT BALL ALLOWING WATER TO IRRIGATE BOTH THE PLANT ROOT BALL AND SOIL BACKFILL MIX.
- ALL PVC LATERAL FITTINGS USED ON THIS PROJECT SHALL BE ULTRA VIOLET RESISTANT SCH. 40 PVC MATERIAL. NO EXCEPTIONS ALLOWED.
- ALL SPRINKLER HEADS SPECIFIED ON THIS PROJECT HAVE BEEN SPECIFIED WITH A BUILT IN CHECK VALVE. ALL SPRINKLER HEADS USED ON THIS PROJECT MUST BE FURNISHED WITH A CHECK VALVE TO PREVENT LOW HEAD DRAINAGE. THE G.P.H. PRODUCTS SPECIFIED FOR THIS PROJECT CAN PREVENT LOW HEAD DRAINAGE UP TO 9'-3" IN ELEVATION CHANGE. ENSURE THAT ALL SPRINKLER HEADS INSTALLED ON ANY LATERAL SYSTEM DO NOT EXCEED THE 9'-3" MAXIMUM OPERATING RANGE FOR PROPER OPERATION OF THE CHECK VALVE AS DESIGNED ON THE IRRIGATION PLAN. SHOULD SIGNIFICANT DEVIATIONS IN THE LATERAL PIPING INSTALLATION BE MADE BY THE INSTALLING CONTRACTOR WITHOUT THE ADVANCED KNOWLEDGE OF THE LANDSCAPE ARCHITECT, THE CONTRACTOR WILL BE DIRECTED TO CORRECT THE LATERAL PIPING INSTALLATION TO THE SATISFACTION OF THE LANDSCAPE ARCHITECT TO PREVENT LOW HEAD DRAINAGE FROM OCCURRING ON SITE WITHOUT ANY COST TO THE OWNER.

REMOTE CONTROL VALVE KEY

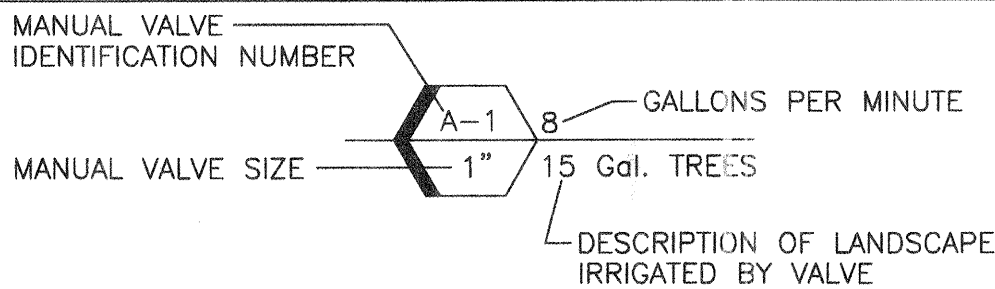

IRRIGATION CALCULATIONS

CALCULATIONS - VALVE A-1		8.0 GPM
AVAILABLE WATER PRESSURE @ EXISTING PUMP		85.0 PSI
LOSS THROUGH 2" MAINLINE TO PRES. REDUCING VALVE		1.4 PSI
PRESSURE REDUCING VALVE SET AT 50.0 PSI		50.0 PSI
LOSS FROM PRESSURE REDUCING VALVE TO WATER FILTER		0.1 PSI
LOSS AT WATER FILTER		0.2 PSI
LOSS FROM WATER FILTER TO MANUAL ANGLE VALVE		0.3 PSI
LOSS @ MANUAL ANGLE VALVE		1.0 PSI
DRIP PRESSURE REGULATING FILTER SET AT		40.0 PSI
LOSS FROM PRESSURE REGULATING FILTER TO LAST HEAD		2.6 PSI
LOSS DUE TO ELEVATION CHANGE		1.7 PSI
LOSS THROUGH FITTINGS		2.1 PSI
TOTAL FRICTION LOSS FROM PRESSURE REGULATING FILTER		6.4 PSI
AVAILABLE DOWNSTREAM PRESSURE AT PRESSURE REGULATING FILTER		40.0 PSI
OPERATING PSI		33.6 PSI

PROJECT KEY NOTES

- (A) IRRIGATION POINT OF CONNECTION:**  
EXISTING NON-POTABLE IRRIGATION WELL WATER SOURCE EXISTING ON NATURE CONSERVANCY PROPERTY LOCATED APPROXIMATELY 2000 FEET TO THE EAST OF THIS PROJECT. CONTRACTOR TO VERIFY THE EXACT DISTANCE IN THE FIELD. EXCAVATE AND EXPOSE THE EXISTING IRRIGATION MAINLINE SOURCE DOWNSTREAM OF EXISTING BACKFLOW DEVICES FROM WELL AT LOCATION CLOSEST TO THIS PROJECT. CUT MAINLINE AND INSTALL A NEW TEE PROVIDING AN 2" WATER SOURCE FOR THIS PROJECT. INSTALL A NEW SCH. 80 PVC BALL VALVE IN A VALVE BOX FOR USE AS AN ISOLATION VALVE. TRENCH AND INSTALL MAINLINE TO PROJECT SITE AND INSTALL MAINLINE AND IRRIGATION VALVES AS PER PLAN.
- (B) MAINLINE WATER FILTER ON BRASS RISERS 24" ABOVE FINISH GRADE UPSTREAM OF MASTER VALVE**  
INSTALL A 2" STEEL WATER FILTER ON 2" IRRIGATION MAINLINE UPSTREAM OF ALL MANUAL SPRINKLER VALVE ASSEMBLIES. INSTALL THE FILTER ON BRASS RISERS, 24" ABOVE FINISH GRADE. THE FILTER SHALL BE EQUIPPED WITH A 130 MICRON MESH SCREEN. INSTALL A 2" PRESSURE REDUCING VALVE ON THE BRASS RISER ON THE INLET SIDE OF THE WATER FILTER. SET PRESSURE REDUCING VALVE TO A 50.0 PSI DOWNSTREAM PRESSURE.

IRRIGATION LEGEND

SYMBOL	DESCRIPTION	MANUFACTURER	MODEL / REMARKS
----	BURIED MAINLINE	PACIFIC PLASTICS	CLASS 315 PVC 'CYCLE FLOW' PURPLE COLORED PIPE SUITABLE FOR NON POTABLE WATER - 2" SIZE & LARGER - SOLVENT WELD - 24" BELOW GRADE
----	BURIED MAINLINE	PACIFIC PLASTICS	SCH. 40 PVC 'CYCLE FLOW' PURPLE COLORED PIPE SUITABLE FOR NON POTABLE WATER - 1-1/2" SIZE & SMALLER - SOLVENT WELD - 24" BELOW GRADE
----	ULTRA VIOLET TREATED PVC LATERAL INSTALLED ON GRADE	PACIFIC PLASTICS	'SOLAR PROOF' ULTRAVIOLET RESISTANT SCH. 40 PVC - SOLVENT WELD - STAPLE TO GRADE #4 X 24" REBAR J-HOOKS @ 4'-0" O.C. 1" SIZES NOTED / MINIMUM 3/4" SIZE FOR REMAINING SYSTEM - USE TO ASSEMBLE BURIED PVC REMOTE CONTROL VALVE ASSEMBLIES AND SLEEVES AS WELL
----	FLEXIBLE PVC HOSE INSTALLED ON GRADE	G.P.H. INC.	SCH. 40 PVC FLEXIBLE PVC HOSE - MODEL GPVCSSAR050IRR 'STICKY STRIPE' - 3/8" IPS SIZE - SOLVENT WELD TO G.P.H. PVC MALES ADAPTERS, G436073B, BLACK 3/8" IPS, WITH IPS P-70 PRIMER & 795 PVC SOLVENT CEMENT - STAPLE TO GRADE W/ G.P.H. GALV. STAPLES, MODEL GTDS050, @ 3'-0" O.C.
⊗	SCH. 80 PVC BALL VALVE	COLONIAL / LASCO	VXX101N-SC SERIES - LINE SIZE - IN PURPLE COLORED STANDARD RECTANGULAR VALVE BOX
⊗	PRESSURE REDUCING VALVE	WILKINS	500HLR SERIES - 2" SIZE - SET AT 50.0 PSI - INSTALLED IN PURPLE COLORED JUMBO VALVE BOX WITH PURPLE LID
⊗	IRRIGATION MAINLINE FILTER	AMAD	MODEL #2-0200-1150-1013 - 130 MICRON MESH SCREEN - 2" STEEL BODY - THREADED INLET AND OUTLET - INSTALL 24" ABOVE GRADE ON BRASS RISERS
▲	QUICK COUPLER	RAIN BIRD	44 NP - 1" SIZE - TWO PIECE RED BRASS BODY WITH PURPLE LOCKING RUBBER COVER - IN A PURPLE 9" ROUND VALVE BOX
⊗	DRIP REMOTE CONTROL VALVE ASSEMBLY	CHAMPION / RAIN BIRD	CHAMPION BRASS MANUAL ANGLE VALVE WITH UNION AND RISING SWIVEL, MODEL NUMBER 300RS-100, 1" SIZE, WITH A RAIN BIRD PRESSURE REGULATING FILTER, 1" SIZE, MODEL NUMBER PRF-100-RBY WITH A 200 MESH (75 MICRON) STAINLESS STEEL FILTER SCREEN.
⊗	PVC FLUSH VALVE	SPEARS	SCH. 40 PVC BALL VALVE - COMPACT SERIES - LINE SIZE - INSTALLED IN A PURPLE RECTANGULAR VALVE BOX WITH 4'-0" FLEX HOSE
●	PRESSURE COMPENSATING 2 GPH DRIP EMITTER W/ BUILT IN CHECK VALVE	G.P.H.	GPSTCV2MR (1/2" FPT / 2.0 GPH) - EMITTER W/ CHECK VALVE & PURPLE CAP - ATTACHED TO 1/2" G.P.H. 'STICKY STRIPE' FLEX PVC MODEL GP/CSSAR050IRR W/ (2) BLACK COLORED PVC MALE ADAPTERS, G.P.H. MODEL G436073B
■	PRESSURE COMPENSATING .25 GPM FLOOD BUBBLER W/ BUILT IN CHECK VALVE	G.P.H.	GPBCBV25R (1/2" FPT / .25 GPM) EUBBLER W/ CHECK VALVE & PURPLE CAP ATTACHED TO 1/2" G.P.H. 'STICKY STRIPE' FLEX PVC MODEL GPVCSSAR050IRR W/ (2) BLACK COLORED PVC MALE ADAPTERS, G.P.H. MODEL G436005B
■	TREE BUBBLERS	G.P.H.	GPBCBV50R (1/2" FPT / .50 GPM) EUBBLER W/ CHECK VALVE & PURPLE CAP - ATTACHED TO 1/2" G.P.H. 'STICKY STRIPE' FLEX PVC MODEL GPVCSSAR050IRR W/ (2) BLACK COLORED PVC MALE ADAPTERS, G.P.H. MODEL G436005B





SAVE DATE: 3/23/15 FRED P:\PROJECTS\WMP0071401 MEINERS OAKS SWALE DESIGN\LANDSCAPE\LANDSCAPE\1401 SHEET 7 PLANTING.DWG  
PLOT DATE: 3/23/15

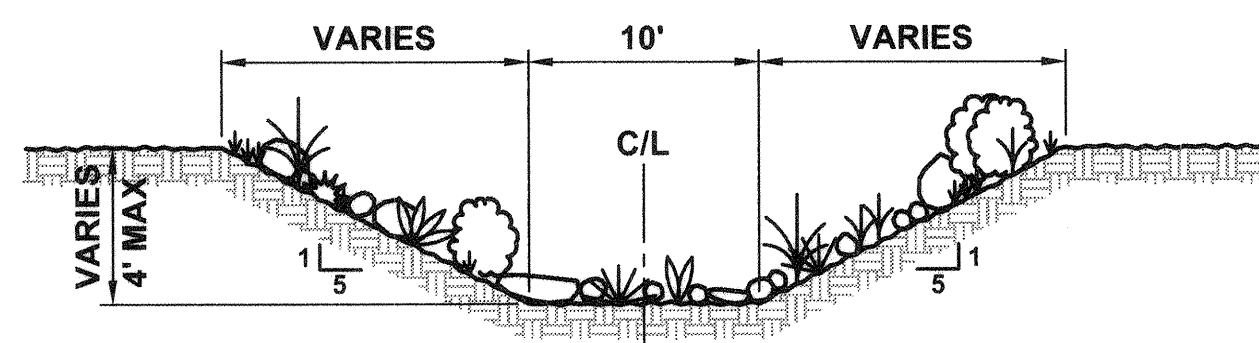
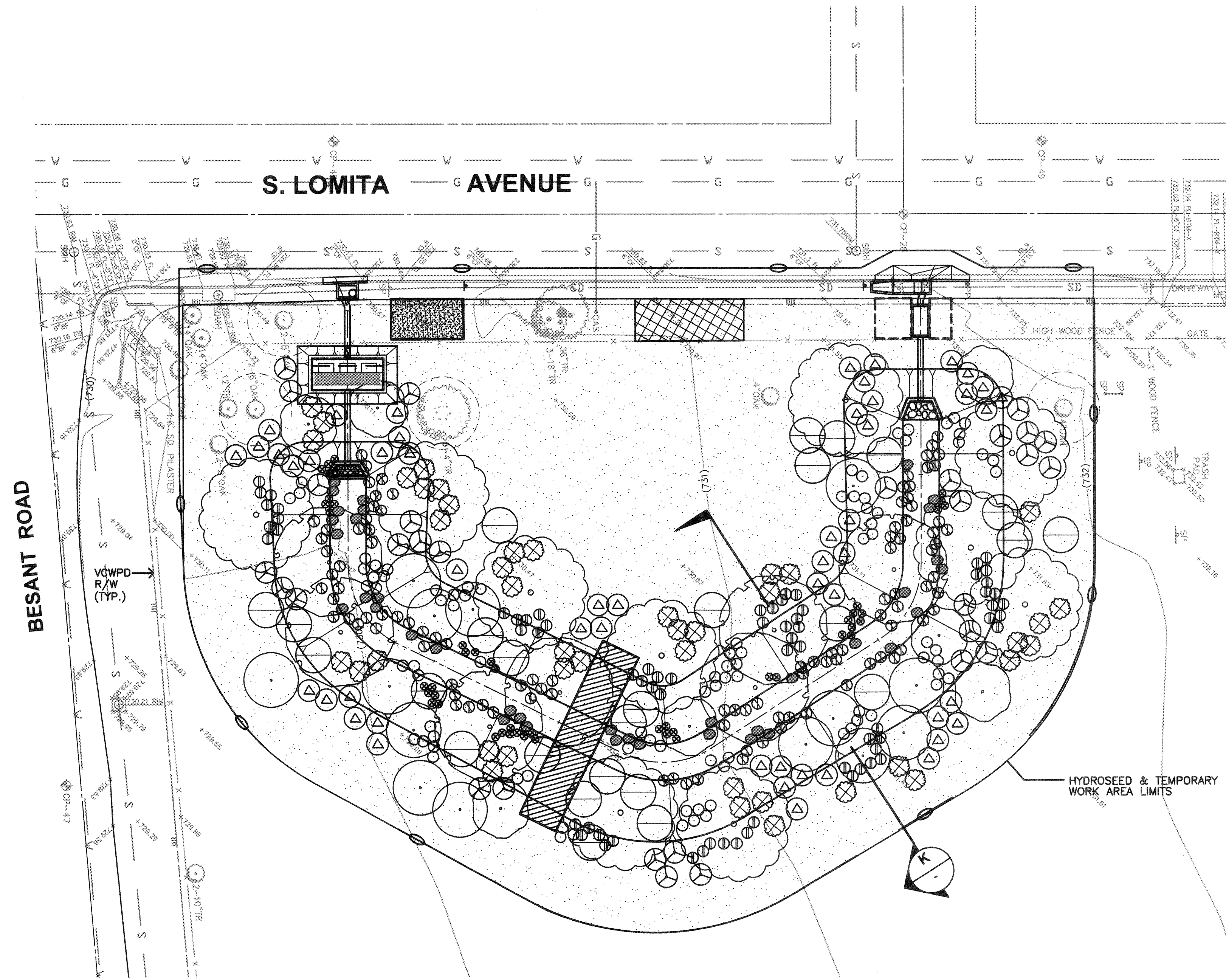

SECTION  
SCALE: N.T.S.

K

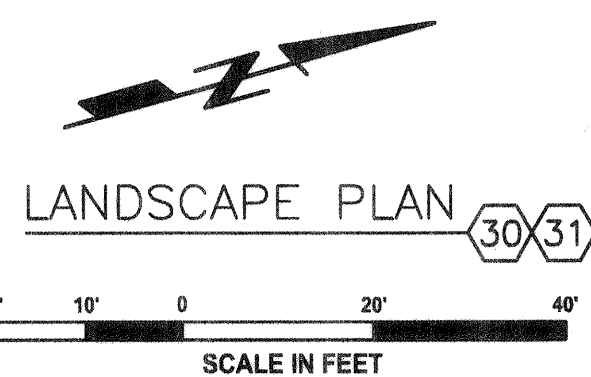

LANDSCAPE PLAN 30 31

### LEGEND

SYMBOL	BOTANICAL NAME/ COMMON NAME	SIZE	QUAN	HT. & SPRED.	WUCOLS RATING	DETAIL REF.
TREES						
	PLATANUS RACEMOSA CALIFORNIA SYCAMORE	15 GAL	7	12' X 5'	L	9/SHEET 7 10/SHEET 7
	QUERCUS LOBATA VALLEY OAK	15 GAL	10	12' X 5'	L	9/SHEET 7 10/SHEET 7
	HETEROMELES ARBUTIFOLIA TOYON	1 GAL	14	8' X 3'	L	9/SHEET 7
	RHAMNUS ILLICIFOLIA HOLLYLEAF REDBERRY	1 GAL	7	8' X 3'	L	9/SHEET 7
SHRUBS						
	RIBES SPECIOSUM FUCHSIA-FLOWERING GOOSEBERRY	1 GAL	30		L	9/SHEET 7
	BACCHARIS SALICIFOLIA MULE FAT	1 GAL	70		L	9/SHEET 7
	JUNCUS PATENS CALIFORNIA GRAY RUSH	1 GAL	106		L	9/SHEET 7
	CLEMATIS LIGUSTICIFOLIA WESTERN WHITE CLEMATIS	1 GAL	42		L	9/SHEET 7
	MUHLENBERGIA RIGENS DEER GRASS	1 GAL	90		L	9/SHEET 7
	RANUNCULUS CALIFORNICUS BUTTERCUPS	1 GAL	47		L	9/SHEET 7
	SAMBUCUS MEXICANA TAPIO	1 GAL	26		L	9/SHEET 7
	SALVIA LEUCOPHYLLA PURPLE SAGE	1 GAL	52		L	9/SHEET 7
	BOULDERS SEE SPECIFICATIONS	2'X3'	37			
	HYDROSEED MIX SEE SPECIFICATIONS				L	

#### NOTES:

- ALL SIDE SLOPES SHALL RECEIVE COIR MATT 400 IN ACCORDANCE WITH CASQA BMP FACT SHEET EC-7. OVERLAPS AND STAPLING PER MANUFACTURER'S RECOMMENDATION.
- SEED MIX SHALL BE HYSDROSEED IN ACCORDANCE WITH CASQA BMP FACT SHEET EC-4.

REVISION	DESCRIPTION	APP.	DATE
D			
C			
B			
A			

PREPARED BY:	JORDAN, GILBERT & BAIN LANDSCAPE ARCHITECTS, INC. 3350 LOMA VISTA ROAD, VENTURA CA 93003 (805) 642-3841 FAX (805) 642-8814
--------------	---

MG	DESIGNED
TC	DRAWN
MG	CHECKED

PROJECT MANAGER	3-18-15
DATE	
DEPUTY DIRECTOR	3-26-2015
DATE	
DISTRICT DIRECTOR	3/27/2015
DATE	

COUNTY OF VENTURA  
PUBLIC WORKS AGENCY  
WATERSHED PROTECTION DISTRICT

SPEC. NO.	WP15-14
PROJ. NO.	40545

URBAN LID RETROFIT AT MEINERS OAKS  
LANDSCAPE PLAN

SHEET	7
OF	8
DRAWING NO.	Y-1-836

